



SENTRON, switch disconnecter 3LD, main switch, 3-pole, Iu: 160 A, operating performance / at AC-23 A at 400 V: 75 kW, installation in distribution boards, knob-operated mechanism, black, handle direct at the switch

Model	
product brand name	SENTRON
product designation	3LD Switch disconnecter
design of the product	Main switch
display version / for switch position indicator manual operation	1 ON - 0 OFF
type of switch	DIN-rail mounting
design of the actuating element	selector switch
color / of the actuating element	black
design of handle	knob-operated mechanism, black
type of the driving mechanism / motor drive	No
General technical data	
number of poles	3
size of switch disconnecter	5
mechanical service life (switching cycles) / typical	100 000
electrical endurance (switching cycles)	
• at AC-23 A / at 690 V	6 000
operating frequency / maximum	50 1/h
degree of pollution	3
Voltage	
insulation voltage / rated value	690 V
surge voltage resistance / rated value	8 kV
operating voltage	
• at AC / rated value	690 V
operating frequency / rated value	
• minimum	50 Hz
• maximum	60 Hz
Protection class	
protection class IP	IP40
protection class IP / on the front	IP40
Dissipation	
power loss [W] / for rated value of the current / at AC / in hot operating state / per pole	36 W
Current	
operational current / rated value	160 A
operational current	
• at 40 °C / rated value	160 A
• at 45 °C / rated value	160 A
• at 50 °C / rated value	160 A

<ul style="list-style-type: none"> at 55 °C / rated value 	160 A
<ul style="list-style-type: none"> at AC / rated value 	160 A
Main circuit	
operational current	
<ul style="list-style-type: none"> at AC-21 / at 690 V / rated value 	160 A
<ul style="list-style-type: none"> at AC-21 A / at 240 V / rated value 	160 A
<ul style="list-style-type: none"> at AC-21 A / at 400 V / rated value 	160 A
<ul style="list-style-type: none"> at AC-21 A / at 440 V / rated value 	160 A
<ul style="list-style-type: none"> at AC-23 A / at 400 V / rated value 	132 A
operating power	
<ul style="list-style-type: none"> at AC-23 A / at 240 V / rated value 	132 kW
<ul style="list-style-type: none"> at AC-23 A / at 400 V / rated value 	132 kW
<ul style="list-style-type: none"> at AC-23 A / at 440 V / rated value 	132 kW
<ul style="list-style-type: none"> at AC-23 A / at 690 V / rated value 	45 kW
<ul style="list-style-type: none"> at AC-3 / at 240 V / rated value 	35 kW
<ul style="list-style-type: none"> at AC-3 / at 400 V / rated value 	50 kW
<ul style="list-style-type: none"> at AC-3 / at 690 V / rated value 	37 kW
Auxiliary circuit	
number of CO contacts / for auxiliary contacts	0
number of NC contacts / for auxiliary contacts	0
number of NO contacts / for auxiliary contacts	0
operating voltage / of auxiliary contacts / at AC / maximum	500 V
continuous current / of the auxiliary contact / rated value	10 A
insulation voltage / of the auxiliary switch / rated value	500 V
Suitability	
suitability for use	
<ul style="list-style-type: none"> main switch 	Yes
<ul style="list-style-type: none"> switch disconnecter 	Yes
<ul style="list-style-type: none"> EMERGENCY OFF switch 	No
<ul style="list-style-type: none"> safety switch 	Yes
<ul style="list-style-type: none"> maintenance/repair switch 	Yes
Product details	
product feature / can be locked into OFF position	Yes
accessories	
product extension / optional	
<ul style="list-style-type: none"> motor drive 	No
<ul style="list-style-type: none"> voltage trigger 	No
number of connectable NC contacts / for auxiliary contacts / attachable / maximum	2
number of connectable NO contacts / for auxiliary contacts / attachable / maximum	4
number of connectable CO contacts / for auxiliary contacts / attachable / maximum	0
number of bracket locks / maximum	3
hasp thickness / of the bracket locks	4 ... 6 mm
Short circuit	
conditional short-circuit current / with line-side fuse protection	
<ul style="list-style-type: none"> at 690 V / by gG fuse / rated value 	50 kA
let-through current / with closed switch	
<ul style="list-style-type: none"> at 240 V / for combination switch + gG fuse / maximum 	15 kA
<ul style="list-style-type: none"> at 440 V / for combination switch + gG fuse / maximum 	15 kA
<ul style="list-style-type: none"> at 690 V / for combination switch + gG fuse / maximum permissible 	15 kA
I ² t value / with closed switch	
<ul style="list-style-type: none"> at 240 V / for combination switch + gG fuse / maximum 	185 kA ² .s
<ul style="list-style-type: none"> at 440 V / for combination switch + gG fuse / maximum 	185 kA ² .s

<ul style="list-style-type: none"> at 690 V / for combination switch + gG fuse / maximum 	185 kA2.s
design of the fuse link	
<ul style="list-style-type: none"> for short-circuit protection of the main circuit / required 	fuse gL/gG: 160 A
<ul style="list-style-type: none"> for short-circuit protection of the auxiliary switch / required 	fuse gL/gG: 10 A
operational current / of upstream fuse / rated value	160 A
according UL	
operational current / at AC / according to UL 508/UL 60947-4-1 / rated value	180 A
operating voltage / at AC / at 50/60 Hz / according to UL 508/UL 60947-4-1 / rated value	600 V
active power [hp] / at AC / at 480 V / according to UL 508/UL 60947-4-1 / rated value	75
active power [hp] / at AC / at 600 V / according to UL 508/UL 60947-4-1 / rated value	50
short-time withstand current (SCCR) / at 600 V / according to UL 508/UL 60947-4-1	10 kA
continuous current / of upstream fuse / according to UL / rated value	200 A
type of fuse / according to UL	RK5
Connections	
AWG number / as coded connectable conductor cross section / solid	
<ul style="list-style-type: none"> minimum 	1
type of connectable conductor cross-sections / for copper conductor	
<ul style="list-style-type: none"> solid 	1x (16 ...185mm ²)
<ul style="list-style-type: none"> finely stranded / with core end processing 	1x (16...150mm ²)
<ul style="list-style-type: none"> stranded 	1x (16...185mm ²)
type of connectable conductor cross-sections / for auxiliary contacts	
<ul style="list-style-type: none"> solid 	2x (0.75 ... 2.5 mm ²), 1x 4 mm ²
<ul style="list-style-type: none"> finely stranded / with core end processing 	2x (0.75 ... 1.5 mm ²), 1x 2.5 mm ²
<ul style="list-style-type: none"> stranded 	2x (0.75 ... 2.5 mm ²), 1x 4 mm ²
type of electrical connection	
<ul style="list-style-type: none"> for main current circuit for auxiliary contacts 	box terminal connection terminals
Mechanical Design	
height	169 mm
width	112 mm
depth	94 mm
type of device	fixed mounting
fastening method	Built-in unit fixed-mounted version
fastening method	
<ul style="list-style-type: none"> 4-hole front mounting 	No
<ul style="list-style-type: none"> front mounting with central attachment 	No
<ul style="list-style-type: none"> rail mounting 	No
net weight	2 040 g
Environmental conditions	
ambient temperature / during operation	
<ul style="list-style-type: none"> minimum 	-25 °C
<ul style="list-style-type: none"> maximum 	55 °C
ambient temperature / during storage	
<ul style="list-style-type: none"> minimum 	-25 °C
<ul style="list-style-type: none"> maximum 	55 °C
General Product Approval	Declaration of Conformity



[Confirmation](#)



EG-Konf.

Declaration of Conformity	Test Certificates	other
---------------------------	-------------------	-------



[Type Test Certificates/Test Report](#)

[Special Test Certificate](#)

[Miscellaneous](#)

[Environmental Confirmations](#)

Further information

Information- and Downloadcenter (Catalogs, Brochures,...)

<http://www.siemens.com/lowvoltage/catalogs>

Industry Mall (Online ordering system)

<https://mall.industry.siemens.com/mall/en/en/Catalog/product?mfb=3LD2330-0TK11>

Service&Support (Manuals, Certificates, Characteristics, FAQs,...)

<https://support.industry.siemens.com/cs/ww/en/ps/3LD2330-0TK11>

Image database (product images, 2D dimension drawings, 3D models, device circuit diagrams, ...)

http://www.automation.siemens.com/bilddb/cax_en.aspx?mfb=3LD2330-0TK11

CAX-Online-Generator

<http://www.siemens.com/cax>

Tender specifications

<http://www.siemens.com/specifications>

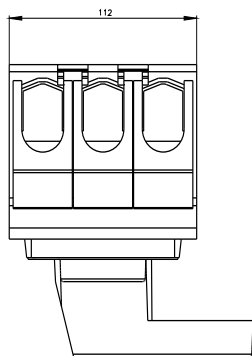
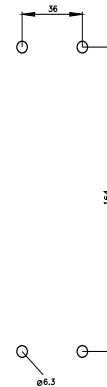
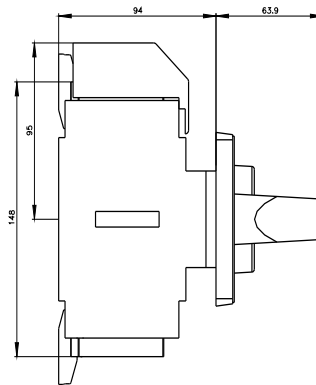
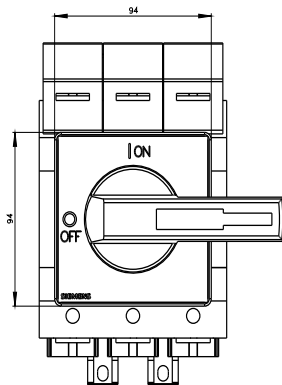

-Q1



-CI



