



circuit breaker 3VA2 IEC frame 250 breaking capacity class M Icu=55kA @ 415V 3-pole, motor protection ETU350M, LSI, In=200A overload protection Ir=80A...200A short-circuit protection Isd=3...15 x Ir, li=15 x In nut keeper kit

| Model | |
|--|-----------------------------|
| product brand name | SENTRON |
| product designation | Molded case circuit breaker |
| Product version | Motor protection |
| design of the overcurrent release | ETU350M |
| protection function of the overcurrent release | LSI |
| number of poles | 3 |
| General technical data | |
| rated insulation voltage Ui | 800 V |
| operating power / at AC-3 / at 400 V | 75 000 W |
| operating power / at AC-3 / at 230 V | 37 000 W |
| power loss [W] / maximum | 46 W |
| Active power loss / for rated value of the current / at AC / in hot operating state / per pole | 15.33 W |
| mechanical service life (switching cycles) / typical | 25 000 |
| Electrical endurance (switching cycles) / at AC-1 / at 380/415 V 50/60 Hz | 12 000 |
| Electrical endurance (switching cycles) / at AC-1 / at 690 V 50/60 Hz | 8 400 |
| Electrical endurance (switching cycles) / at AC-3 / at 380/415 V 50/60 Hz | 6 000 |
| Neutral conductors / upgradeable/retrofitable | No |
| ground-fault monitoring version | Without |
| product function | |
| • communication function | No |
| • phase failure detection | Yes |
| • other measurement function | No |
| net weight | 2.3 kg |
| Current | |
| Max. rated operational current of the frame size | 250 A |
| Courant permanent assigné lu | 200 A |
| operational current | |
| • at 40 °C | 200 A |
| • at 45 °C | 200 A |
| • at 50 °C | 200 A |
| • at 55 °C | 200 A |
| • at 60 °C | 200 A |
| • at 65 °C | 200 A |

| | | | |
|--|---|------------|----------------------------------|
| <ul style="list-style-type: none"> • at 70 °C | 200 A | | |
| Switching capacity according to IEC 60947 | | | |
| switching capacity class of the circuit breaker | M | | |
| breaking capacity maximum short-circuit current (Icu) <ul style="list-style-type: none"> • at 240 V • at 415 V • at 440 V • at 500 V • at 690 V | 85 kA 55 kA 55 kA 36 kA 3.5 kA | | |
| breaking capacity operating short-circuit current (Ics) <ul style="list-style-type: none"> • at 240 V • at 415 V • at 440 V • at 500 V • at 690 V | 85 kA 55 kA 55 kA 36 kA 3.5 kA | | |
| short-circuit current making capacity (Icm) <ul style="list-style-type: none"> • at 240 V • at 415 V • at 440 V • at 500 V • at 690 V | 187 kA 121 kA 121 kA 75.6 kA 5.2 kA | | |
| Adjustable parameters | | | |
| Adjustable response value current / li min. | 3 000 A | | |
| Adjustable response value current / li max. | 3 000 A | | |
| Ground fault protection / tripping switchable / I2t=ON/OFF | No | | |
| Mechanical Design | | | |
| height [in] | 7.13 in | | |
| Height | 181 mm | | |
| width [in] | 4.13 in | | |
| Width | 105 mm | | |
| depth [in] | 3.39 in | | |
| depth | 86 mm | | |
| Connections | | | |
| arrangement of electrical connectors / for main current circuit | Front terminal | | |
| type of electrical connection / for main current circuit | on both sides nut keeper kit | | |
| Type of connectable conductor cross-section, connection screw, width x thickness , min. | 13 x 1 mm | | |
| Auxiliary circuit | | | |
| product component <ul style="list-style-type: none"> • undervoltage release • voltage trigger • trip indicator | No No No | | |
| number of CO contacts / for auxiliary contacts | 0 | | |
| Accessories | | | |
| product extension / optional / motor drive | Yes | | |
| Environmental conditions | | | |
| protection class IP / on the front | IP40 | | |
| ambient temperature <ul style="list-style-type: none"> • during operation / minimum • during operation / maximum • during storage / minimum • during storage / maximum | -25 °C 70 °C -40 °C 80 °C | | |
| Certificates | | | |
| reference code / acc. to IEC 81346-2 | Q | | |
| General Product Approval | | EMC | Declaration of Conformity |



[Miscellaneous](#)



[UK Declaration of Conformity](#)

| Declaration of Conformity | Test Certificates | Marine / Shipping |
|---------------------------|-------------------|-------------------|
|---------------------------|-------------------|-------------------|



EG-Konf.

[Miscellaneous](#)

[Special Test Certificate](#)



LRS

[CCS / China Classification Society](#)



other

[Confirmation](#)

[Miscellaneous](#)

[Miscellaneous](#)

Further information

Information- and Downloadcenter (Catalogs, Brochures,...)

<http://www.siemens.com/lowvoltage/catalogs>

Industry Mall (Online ordering system)

<https://mall.industry.siemens.com/mall/en/en/Catalog/product?mlfb=3VA2220-5MN32-0AA0>

Service&Support (Manuals, Certificates, Characteristics, FAQs,...)

<https://support.industry.siemens.com/cs/ww/en/ps/3VA2220-5MN32-0AA0>

Image database (product images, 2D dimension drawings, 3D models, device circuit diagrams, ...)

http://www.automation.siemens.com/bilddb/cax_en.aspx?mlfb=3VA2220-5MN32-0AA0

CAX-Online-Generator

<http://www.siemens.com/cax>

Tender specifications

<http://www.siemens.com/specifications>

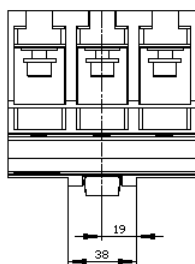
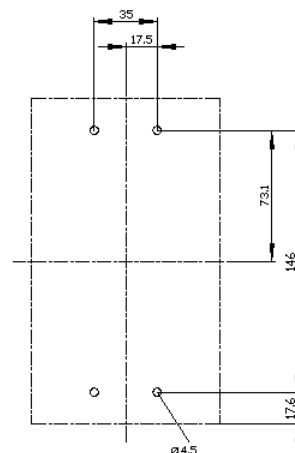
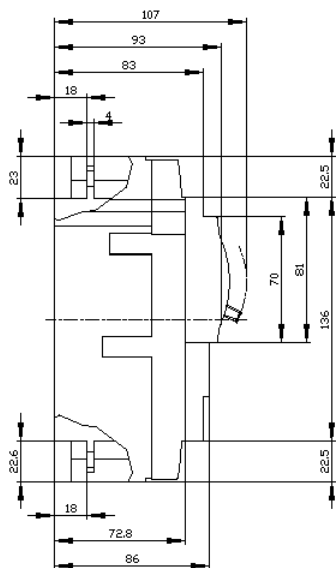
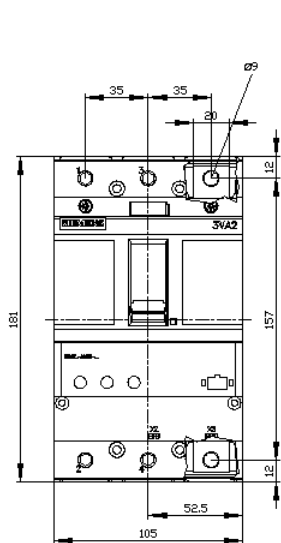

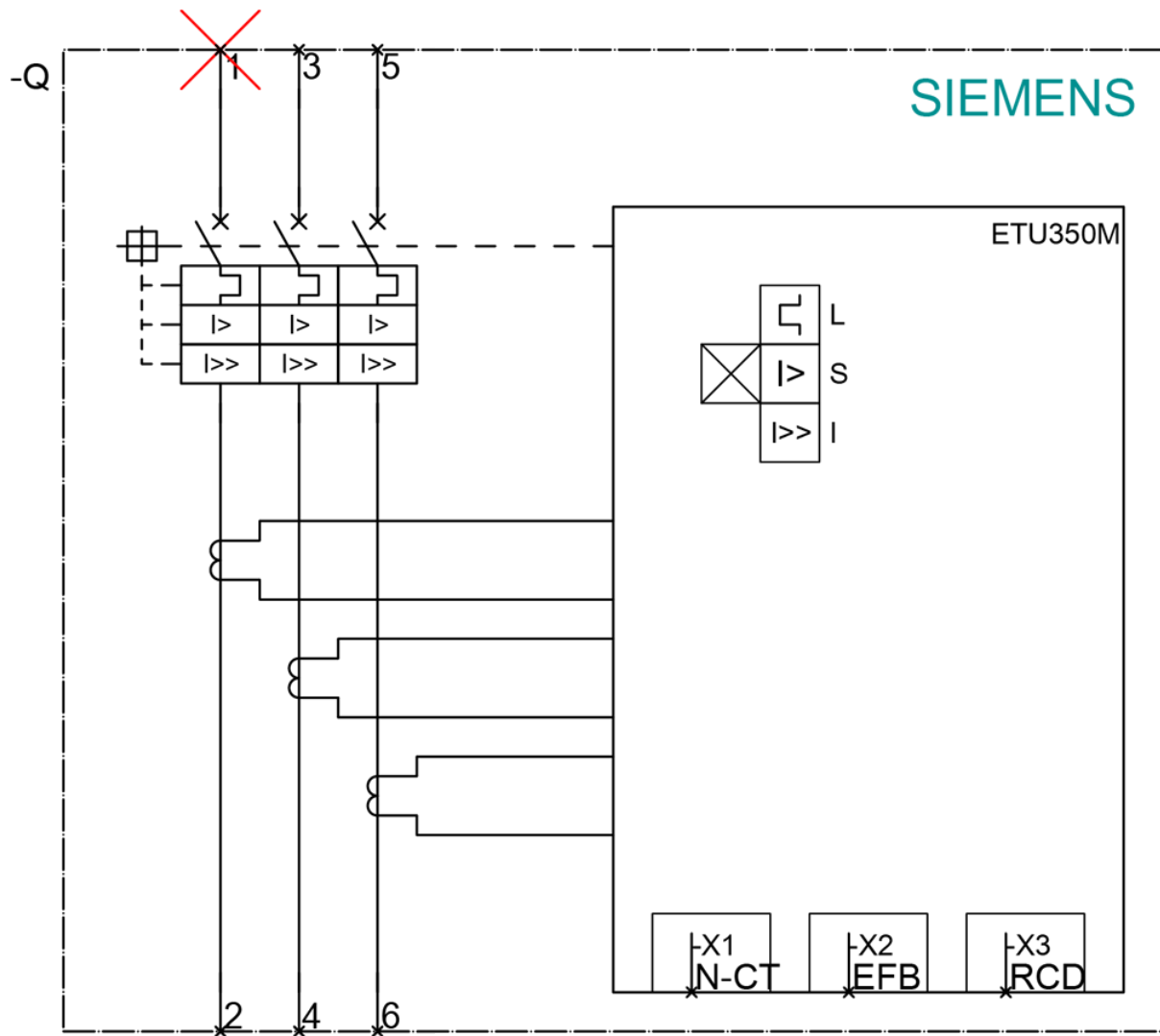

last modified:

6/11/2021 