



circuit breaker 3VA2 IEC frame 400 breaking capacity class M Icu=55kA @ 415V 3-pole, motor protection ETU350M, LSI, In=250A overload protection Ir=100A...250A short-circuit protection Isd=3...15 x Ir, li=15 x In nut keeper kit

Model	
product brand name	SENTRON
product designation	Molded case circuit breaker
Product version	Motor protection
design of the overcurrent release	ETU350M
protection function of the overcurrent release	LSI
number of poles	3
General technical data	
rated insulation voltage Ui	800 V
operating power / at AC-3 / at 400 V	110 000 W
operating power / at AC-3 / at 230 V	55 000 W
power loss [W] / maximum	37.5 W
Active power loss / for rated value of the current / at AC / in hot operating state / per pole	12.5 W
mechanical service life (switching cycles) / typical	20 000
Electrical endurance (switching cycles) / at AC-1 / at 380/415 V 50/60 Hz	6 000
Electrical endurance (switching cycles) / at AC-1 / at 690 V 50/60 Hz	4 200
Electrical endurance (switching cycles) / at AC-3 / at 380/415 V 50/60 Hz	4 000
Neutral conductors / upgradeable/retrofitable	No
ground-fault monitoring version	Without
product function	
• communication function	No
• phase failure detection	Yes
• other measurement function	No
net weight	4.3 kg
Current	
Max. rated operational current of the frame size	400 A
Courant permanent assigné lu	250 A
operational current	
• at 40 °C	250 A
• at 45 °C	250 A
• at 50 °C	250 A
• at 55 °C	250 A
• at 60 °C	250 A
• at 65 °C	250 A

<ul style="list-style-type: none"> at 70 °C 	250 A	
Switching capacity according to IEC 60947		
switching capacity class of the circuit breaker	M	
breaking capacity maximum short-circuit current (Icu) <ul style="list-style-type: none"> at 240 V at 415 V at 440 V at 500 V at 690 V 	85 kA 55 kA 55 kA 36 kA 5 kA	
breaking capacity operating short-circuit current (Ics) <ul style="list-style-type: none"> at 240 V at 415 V at 440 V at 500 V at 690 V 	85 kA 55 kA 55 kA 36 kA 5 kA	
short-circuit current making capacity (Icm) <ul style="list-style-type: none"> at 240 V at 415 V at 440 V at 500 V at 690 V 	187 kA 121 kA 121 kA 75.6 kA 7.5 kA	
Adjustable parameters		
Adjustable response value current / li min.	3 750 A	
Adjustable response value current / li max.	3 750 A	
Ground fault protection / tripping switchable / I2t=ON/OFF	No	
Mechanical Design		
height [in]	9.76 in	
Height	248 mm	
width [in]	5.43 in	
Width	138 mm	
depth [in]	4.33 in	
depth	110 mm	
Connections		
arrangement of electrical connectors / for main current circuit	Front terminal	
type of electrical connection / for main current circuit	on both sides nut keeper kit	
Type of connectable conductor cross-section, connection screw, width x thickness , min.	20 x 1 mm	
Type of connectable conductor cross-section, connection screw, width x thickness , max.	35 x 10 mm	
Auxiliary circuit		
product component <ul style="list-style-type: none"> undervoltage release voltage trigger trip indicator 	No No No	
number of CO contacts / for auxiliary contacts	0	
Accessories		
product extension / optional / motor drive	Yes	
Environmental conditions		
protection class IP / on the front	IP40	
ambient temperature <ul style="list-style-type: none"> during operation / minimum during operation / maximum during storage / minimum during storage / maximum 	-25 °C 70 °C -40 °C 80 °C	
Certificates		
reference code / acc. to IEC 81346-2	Q	
General Product Approval	EMC	Declaration of



[Miscellaneous](#)



EG-Konf.

**Declaration of
Conformity**
Test Certificates
Marine / Shipping
[UK Declaration of
Conformity](#)
[Miscellaneous](#)
[Special Test Certifi-
cate](#)

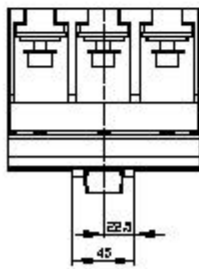
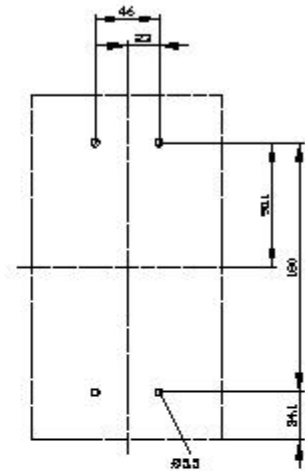
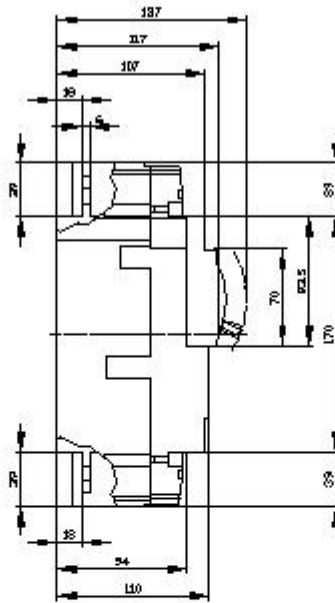
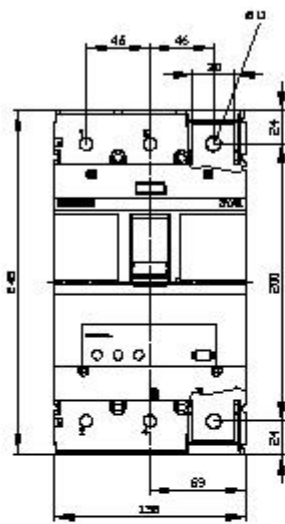
[CCS / China Classi-
fication Society](#)

other
[Miscellaneous](#)
[Confirmation](#)
[Miscellaneous](#)
Further information
Information- and Downloadcenter (Catalogs, Brochures,...)
<http://www.siemens.com/lowvoltage/catalogs>
Industry Mall (Online ordering system)
<https://mall.industry.siemens.com/mall/en/en/Catalog/product?mlfb=3VA2325-5MN32-0AA0>
Service&Support (Manuals, Certificates, Characteristics, FAQs,...)
<https://support.industry.siemens.com/cs/ww/en/ps/3VA2325-5MN32-0AA0>
Image database (product images, 2D dimension drawings, 3D models, device circuit diagrams, ...)
http://www.automation.siemens.com/bilddb/cax_en.aspx?mlfb=3VA2325-5MN32-0AA0
CAX-Online-Generator
<http://www.siemens.com/cax>
Tender specifications
<http://www.siemens.com/specifications>

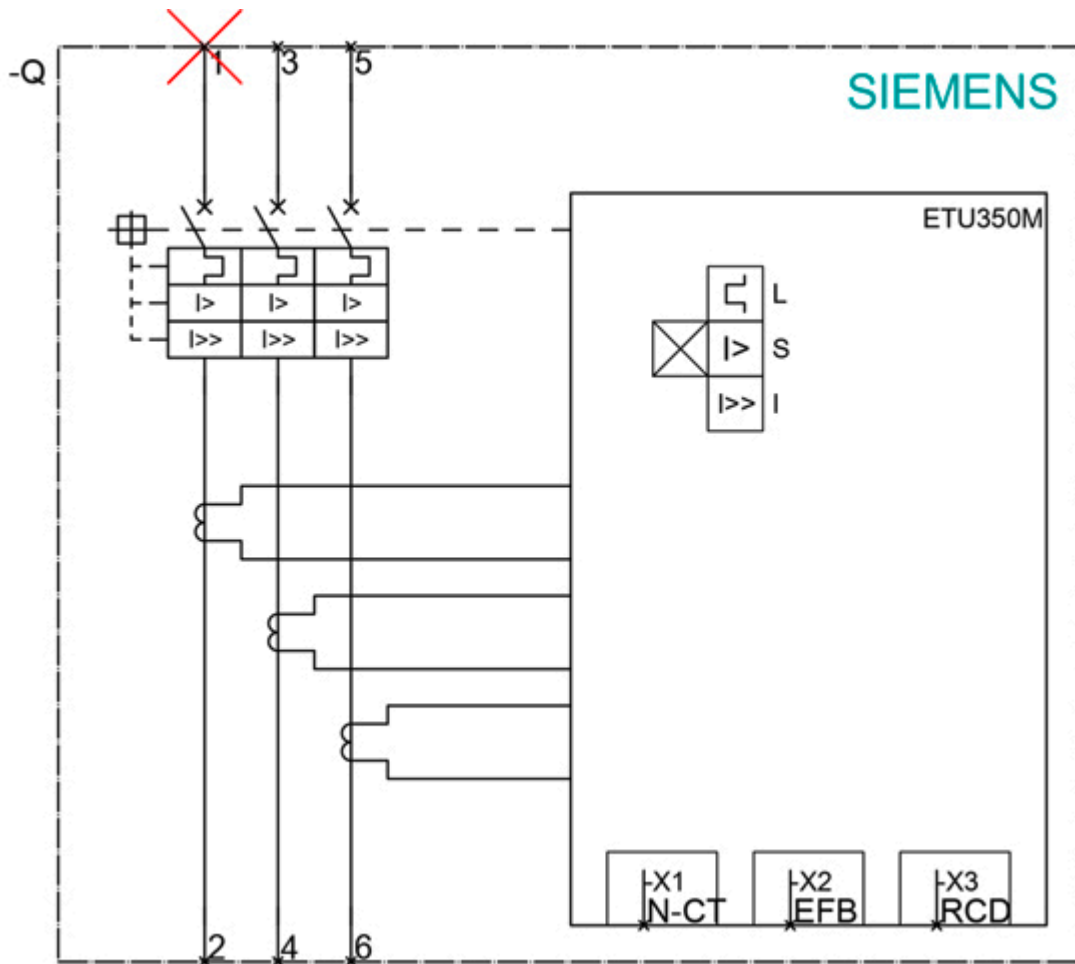



last modified:

6/11/2021